

# SILVERBACK

*GI* By CEDAR CREEK



The Next Generation.....

# New Front Cap = 90° + Turning Radius

- What makes the all new Silverback GII the most exciting 5<sup>th</sup> wheel to hit the market in years?
  - FANTASTIC NEW EXTERIOR
  - A better looking coach with outstanding features



## NOW A 102" WIDEBODY

- ❖ New exterior graphics
- ❖ More Square Footage on a shorter Frame
- ❖ Wider aisles, bathrooms
- ❖ Deeper drawers
- ❖ More room at foot of bed
- ❖ Larger countertops and cabinets
- ❖ No loss of fuel economy
- ❖ No More Sliding Hitches
- ❖ Short Bed Trucks Owners will LOVE this coach

## NEW AUTOMOTIVE STYLE WINDOWS

No exterior frames for clean look, better seal  
Deep tint safety glass for privacy, comfort and protection



**NEW MOLDED LOWER REAR CAP**  
Stylish look with new LED taillights

## **LUXURIOUS NEW INTERIOR**

**All new cherry wood cabinets, furniture, lighting, trim and more!**



- ❖ Dramatic radiused cabinets and counters throughout
- ❖ Wood blinds on all windows
- ❖ All interior window frames trimmed in wood
- ❖ New arched style valances. Solid color sofa, accent pillows
- ❖ Beautiful new double arched fascia on living room and kitchen slides
- ❖ New dinette table with 2 drawer storage and unique chair restraint feature
- ❖ More stylish dinette chairs
- ❖ Recessed halogen lighting in kitchen area
- ❖ Hinged bedroom entry door in all side aisle floorplans
- ❖ New cabinet hardware
- ❖ Recessed area in aisle with two hooks wall for hanging coats
- ❖ Heater ducts in toe kicks at entry, kitchen and upstairs areas





Photographs of New 32WRL





## **ABUNDANCE OF NEW STANDARD FEATURES**

**You thought you'd never see these standard in a SILVERBACK!**

- ❖ **10 Gallon water heater**
- ❖ **15,000 BTU air conditioner**
- ❖ **Aluminum wheels**
- ❖ **All-inclusive docking station with winterizing valves and hose**
- ❖ **Slide selector switch**
- ❖ **Dual battery compartment**
- ❖ **Enclosed and insulated holding and fresh water tanks**
- ❖ **12V/110V/TV outlets in storage compartment**
- ❖ **12V battery disconnect**
- ❖ **Scare lights (2)**
- ❖ **Tie downs in storage compartment**
- ❖ **Create a breeze fan with thermostat in kitchen**
- ❖ **Queen pillow top mattress**
- ❖ **32" LCD TV**
- ❖ **Stylish pin box cover**
- ❖ **Exterior power center for landing gear and slides**

# NEW FLOORPLANS

## Two new side aisle floorplans

### 32WRL SILVERBACK

- ❖ Side aisle bath
- ❖ Rear lounge with opposing slides for lots of room
  - ❖ Excellent galley counter space and storage
  - ❖ Split level counter w/barstools for extra seating
  - ❖ Large entertainment center with 32" LCD TV
- ❖ Gorgeous radius cabinets with arched cabinet doors

## Cedar Creek

### Model 32WRL

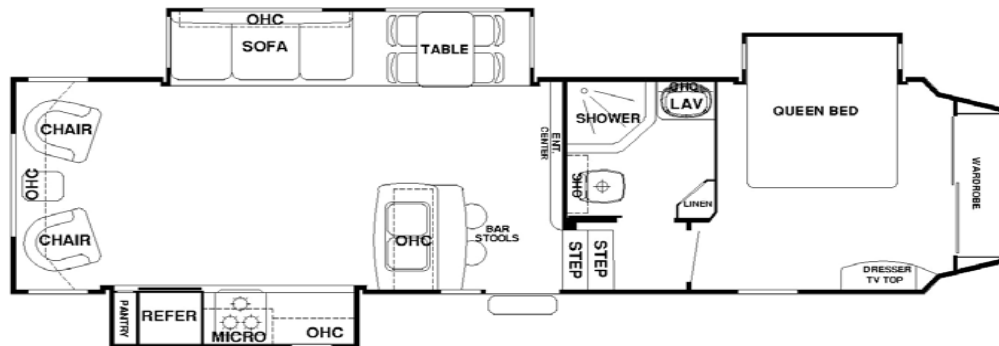

**34'4" Long**

**346.57 Square Feet of Living Space**

# NEW FLOORPLANS

## Two new side aisle floorplans

### 34WBH SILVERBACK

- ❖ Side Aisle Bath
- ❖ Flip up bunks for total of four beds in bunkroom
- ❖ More shelving in bunkroom
- ❖ Better galley counters and drawers
- ❖ Larger pantry
- ❖ Large entertainment center with 32" LCD TV

## Cedar Creek

## Model 34WBH

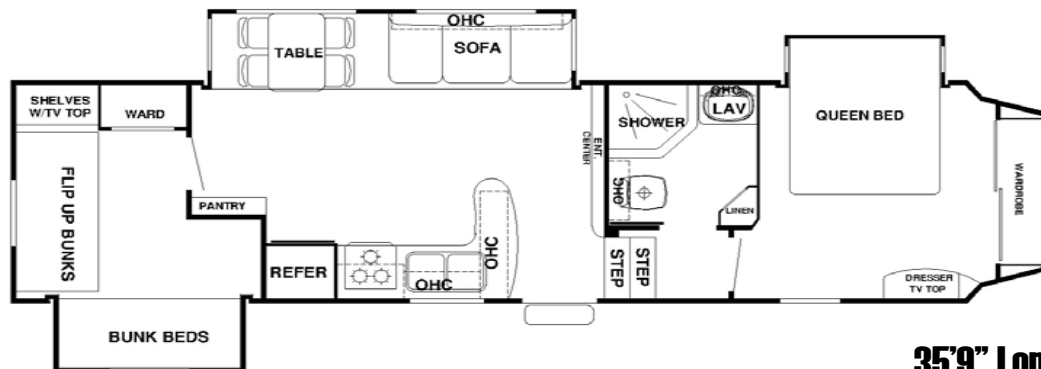

**35'9" Long**

**360.13 Square Feet of Living Space**